

## Hybrid Stepping Motor

Type:34H280-30-8A

### COMMON RATINGS

Step angle: 1.8°

Positional accuracy: +/-5%

Number of Phase: 2

Temperature rise: 80°C Max

Inertia: 1600 gcm<sup>2</sup>

Dielectric strength: 500VDC

Insulation resistance: 100MΩ(500VDC)

Radial play: 0.025mm max.(load 450g)

Insulating class: B

Weight: 2.4 kg

### SPECIFICATIONS

	Holding Torque (2 phases on) N.m ±10%	Rated Current/Phase (Amps DC)	Phase Resistance (ohms) ±10%	Phase Inductance (mH) ±20% Typical
Bipolar(Parallel)	4.2	4.2	0.76	6.66
Bipolar(Series)	4.2	2.1	3.04	26.6
Unipolar	3.0	3.0	1.52	6.66

### DIMENSIONS unit=mm

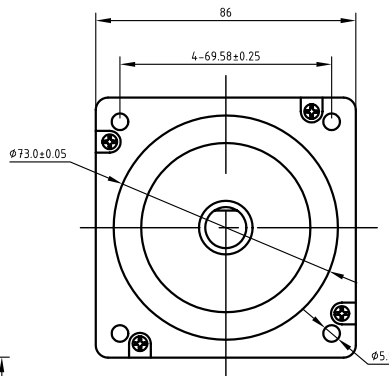
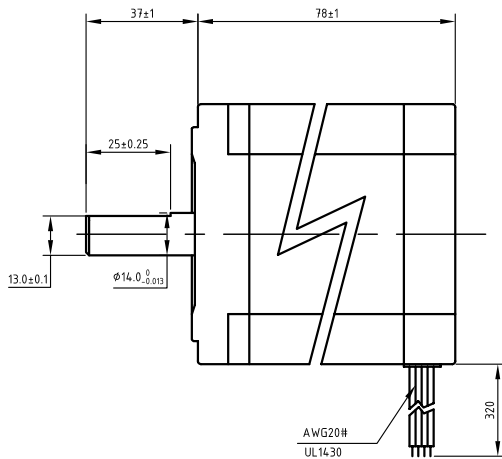

### CONNECTIONS

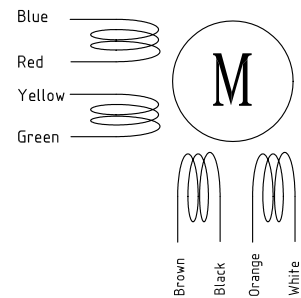

						<b>34H280-30-8A</b>			AutomationMaker.com		
标记	处数	分区	更改文件号	签名	日期						
设计			标准化								
审核											
工艺			批准			共 张	第 张				